

BIMETAL + MOVING IRON

**MAXIMUM DEMAND AMMETERS (bimetallic system)
with moving iron system.**

DOUBLE AMMETERS (INTERCHANGEABLE SCALE)

- Measuring range: 5A, 1A
- Scale: 90°
- Accuracy: 2,5 % (bimetallic syst.) / 1,5% (moving iron system)
- Frequency: 15..100 Hz
- Burden: 2,15 VA

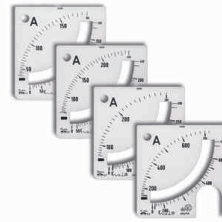

Model		BEC4V	BEC3V	BEC2V**
Dimensions	mm	72x72	96x96	144x144
Approx. weight	kg.	0,23	0,31	0,60
DOUBLE AMMETERS (INTERCHANGEABLE SCALE)				
Module				
Bimetal	1,2xIn	1,2X/5A or 1,2X/1A 2X/5A or 2X/1A		
Moving iron	2xIn			
Scales				
Bimetal	1,2xIn	1,2; 6; 12; 18; 24; 30; 36; 48; 60; 72, 90 A or 120%		
Moving iron	2xIn			
		1..2; 5..10; 10..20; 15..30; 20..40; 25..50; 30..60; 40..80; 50..100; 60..120 or 75..150 A and multiples		

** BEC2V, interchangeable scale not available

DOUBLE AMMETERS WITH CONTACTS

BIMETALLIC SYSTEM WITH ALARM CIRCUIT

- Measuring range: 5A, 1A
- Scale: 90°
- Accuracy: 2,5 % (bimetallic syst.) / 1,5% (moving iron system)
- Frequency: 15..100 Hz
- Burden: 2,15 VA



Models		BEC4VA	BEC3VA	BEC2VA
Dimensions	mm	72x72	96x96	144x144
Approx. weight	kg.	0,40	0,50	0,88
DOUBLE AMMETERS (WITH CONTACTS)				
Module				
Bimetal	1,2xIn	1,2X/5A or 1,2X/1A 2X/5A or 2X/1A		
Moving iron	2xIn			
Scales				
Bimetal	1,2xIn	1,2; 6; 12; 18; 24; 30; 36; 48; 60; 72, 90 A or 120%		
Moving iron	2xIn			
		1..2; 5..10; 10..20; 15..30; 20..40; 25..50; 30..60; 40..80; 50..100; 60..120 or 75..150 A and multiples		

ALARM CIRCUIT:

- Max. with contacts (red LED)
- Aux.V: 100; 110; 230; 400 V (AC.)
- Burden: 3.75 VA (AC.)
- Aux.V: 12; 24; 48 V (DC.)
- Burden: 66; 56; 38 mA (DC.)
- Relay output: 1 Relay (Max. 400 V, 1 A, 200 VA)
- Accuracy: 2%
- Hysteresis: ≤1%
- Adjustable from the front

Dimensions (mm)

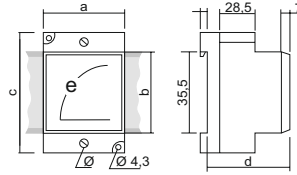

Models	Ranges	a	b	c	d	e	ø
BC5VR	/5 A	52,5	45	75	60	38	M.6

Dimensions (mm)

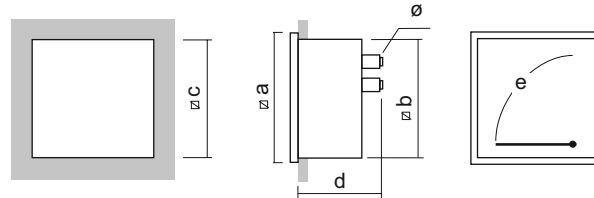

Models	Ranges	∅a	∅b	∅c	d	e	ø
BC5V	/5 A	48	44,5	45 ^{+0,6}	59	38	M.4
BC4V	../1 ../5	72	66,5	68 ^{+0,7}	88	65	M.4
BC3V	../1 ../5	96	89	92 ^{+0,8}	92 88	100	M.4
BC2V	../1 ../5	144	135	138 ⁺¹	88	140	M.4
BC4VA	../1 ../5	72	66,5	68 ^{+0,7}	93	65	M.4
BC3VA	../1 ../5	96	89	92 ^{+0,8}	92	100	M.4
BC2VA	../1 ../5	144	135	138 ⁺¹	92	140	M.4

Dimensions (mm)

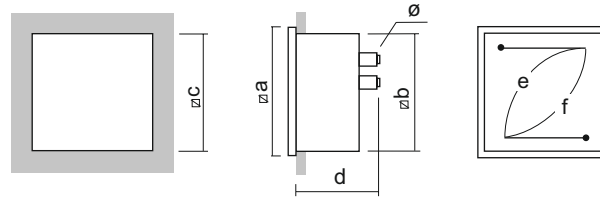

Models	Ranges	∅a	∅b	∅c	d	e	f	ø
BEC4V	../1 ../5	72	66,5	68 ^{+0,7}	124 88	65	65	M.4
BEC3V	../1 ../5	96	89	92 ^{+0,8}	92 88	100	100	M.4
BEC2V	../1 ../5	144	135	138 ⁺¹	88	140	140	M.4
BEC4VA	../1 ../5	72	66,5	68 ^{+0,7}	124	65	65	M.4
BEC3VA	../1 ../5	96	89	92 ^{+0,8}	88	100	100	M.4
BEC2VA	../1 ../5	144	135	138 ⁺¹	88	140	140	M.4

Connection diagrams

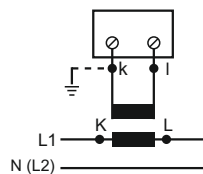

Maximum demand and double ammeters with contacts

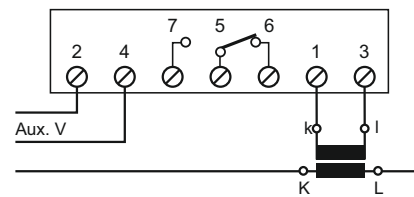

Maximum demand and double ammeters